

3D-IW8, Inteliwasher

4 CHW Logger



Product video is available
on the website



Inteliwasher **3D-IW8** series microplate washer is designed for washing various types of standard 96-well microtitre plates, microstrips as well as microarrays on FastFRAME (rectangular well shape). It is suitable for washing wells with different bottom shapes: flat, U-shape and V-shape. The unit is fully programmable ensuring multi-step solution ripening, aspiration (aspiration, combination of aspiration/liquid dispensing and soaking, as well as soaking cycle during a particular period of time). Dispense system of liquid dosage for each channel separately.

The unit provides:

Washing mode

Rinsing mode

Mixing mode

Single point, two point, circular (circle or rectangular path) aspiration

Possibility of additional solution mixing during time gap between two work cycles

Possibility to use microtest plates by different manufacturers, ensured by automated plate set up (adjusting to different depths of plate wells)

Round-bottom plate and strip washing mode

Possibility of user-defined programs with adjustable parameters.

Catalogue number:

3D-IW8

BS-060102-AAI

4CHW Logger

BS-060102-AK



3D-IW8, Inteliwasher



The unit has 50 programs divided into 5 following aspiration categories (see figure below):

- 1 **Type 1** (1.0–1.9) **IPF96 U/V** is intended for round and V-shape immunoplates, 1 point aspiration.
- 2 **Type 2** (2.0–2.9) **IPF96 FLAT-2** is intended for flat-bottom shape immunoplates, 2 point aspiration.
- 3 **Type 3** (3.0–3.9) **IPF96 FLAT-C** is intended for rectangular shape immunoplates, full-circle aspiration direction.
- 4 **Type 4** (4.0–4.9) **FastFRAME-2** is intended for multi-slide plate* with rectangular wells.
- 5 **Type 5** (5.0–5.9) **FastFRAME-C** is intended for multi-slide* plate with rectangular wells.

* — The **FastFRAME** (Schleicher&Shuel) multi-slide plate or analog plate of another manufacturer, that is compatible with standard 25×76 mm (1×3 inch) glass slides.

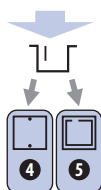
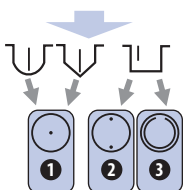
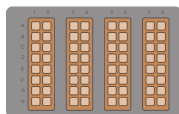
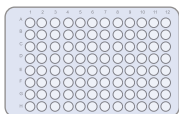

Specifications:

Minimum dispense volume	25 µl
Maximum dispense volume	1600 µl
Dispense increment	25 µl
Dispensing accuracy	±2%
Allowed residual liquid volume in plate well, not more	2 µl
Number of wells washed simultaneously	8
Number of washing cycles	1–15
Aspiration time	1–3 sec
Final aspiration time	1–3 sec
Aspiration/dispensing speed	3 levels
Max. number of channels in a program	2
Choice of 3 washing liquid bottles	
Soaking time	0–300 sec (increment 10 sec)
Shaking time	0–150 sec (increment 5 sec)
Number of washed rows	1 – 12
Time of one plate wash (300 µl), not more	65 sec
Number of programs	50
Plate platform and washing head movement	automated
Indication of operation modes	LCD, 8-line
Dimensions	375 × 345 × 180 mm
Weight with accessories	10.5 kg
External power supply	DC 12 V, 4.16 A
Consumed power, not more	60 W

The unit is designed for use in closed laboratory rooms at temperatures from +10°C to +35°C and relative humidity up to 80% at +25°C decreasing linearly to 50% relative humidity at 35°C.

Logger dimensions	267 × 252 × 97 mm
Logger weight, not more	3 kg

4-channel washing solution weight logger, **4 CHW Logger** provides automatic control of rinsing solution and waste volumes. The washer shows remaining volume for each bottle as percentage and gives a warning message in case of low solution volume or full waste bottle when 4CHW Logger is connected.